



Owner's Manual

Consisting of:

Maintenance Guidelines

Cariola Warranty

Assembly Instructions

Parts & Kits Breakdowns

Tub:

- Wet down before putting concrete in it (makes slide out easier).
- Do not leave material to dry out in it.
- Do not drop sharp objects in it.
- Do not overload.
- Do not drop on nose.
- Wear will occur on nose; it can fail at this area with heavy use.
- The colder out the more susceptible the poly tubs are to breaking when impacted severely.
- If poly tub gets hairy from abrasion inside tub, smooth out by using fine sand paper.
- Plastic tub has UV protection but excessive sunlight over time will weaken plastic, best to store out of sunlight.

Frame:

- Check bolts for tightness.
- Do not impact severely to clean.
- Check handle inserts that they are not loose.
- Frame height can be adjusted by putting a ¼" shim between axle and frame. (See below for more information)

Wheel:

- Do not exceed maximum pressure stated on tire.
- For puncture resistant solution in wheel to work, max pressure is needed as the escaping air carries the sealant to the puncture where the fibers in the sealant form a plug to seal the puncture. (When you are aware of air escaping from puncture, spin the tire to distribute the solution.)
- If tire goes flat:
 - Put air in tire and spin wheel to distribute puncture-resistant solution.
 - If still going flat, add more puncture-resistant solution; the original solution may have been used up.
 - If tire still does not hold pressure, replace tube.
 - Puncture-resistant solution does not seal tube tears or large holes.

Bearings:

- The Ultimate Wheelbarrow uses precision-engineered ball bearings that are pre-greased and sealed. (However, due to the harsh environment to which these bearings are subjected, they may be damaged.) (Bearing number is: 6205-2RS (25mm axle))

Shims:

- These are spacers that can be placed in between axle and frame, and used to raise the frame for more clearance between the ground and nose. Wheelbarrows are sent with 1 set of shims. Additional shims are available for purchase to further increase the height of the frame for more clearance, up to a maximum of 3 per side.

Cariola Warranty

The Company warrants the equipment to be free from defects in material and workmanship under normal use, proper installation and proper operating conditions. Except as to warranties of title, this limited warranty is expressly in lieu of and excludes and supersedes all other warranties and representations, express or implied from the Company, including any implied warranty of merchantability or fitness for any particular use.

The Company's liability under this limited warranty shall be limited to repairing or replacing any parts which prove defective, at its factory in Calgary, Alberta, Canada, if returned to the Company's said factory, with shipping charges prepaid, within a period of 90 days from the date of shipment. There shall be no liability for anticipated profits, nor consequential or incidental damages, direct or indirect, for loss of use of the equipment or of any installation into which the equipment may be put under this limited warranty.

The Company's liability for warranty of component parts included in the equipment which the Company has purchased as a manufactured unit from a recognized manufacturer thereof, shall be no greater than the warranty liability assumed by the supplier or manufacturer of such component parts. In no event shall the Company be liable for consequential or incidental damages resulting directly, or indirectly, from the failure of such component parts.

It is the Company's policy that it is the responsibility of the employer-owner of the equipment, and not the Company, to comply with the provisions and regulations under the Occupational Health & Safety Act of 1970 as well as any other Federal, State, or Local standards which might exist as to health and safety.

Assembly Instructions

Pg 4



Slide axle through the wheel.
Wipe off excess grease.
Slide on the plastic washer and shaft collar (as shown.)



Center axle and tighten shaft collar using a 5/32" Allen Wrench.



Insert tub bolts.
Retaining washers can be used to hold the bolts in place, but are not required.



Place the crosspiece brace over the longer tub bolts (closest to the nose.)
Then put the frame pieces on and loosely attach flange nuts.

* Do not tighten flange nuts at this time!



Attach the nose brace using the 2 1/4" bolts.

*Do not tighten flange nuts at this time!



Attach the back brace on one side of the frame, making sure to keep the flange nut loose.
Then, apply outward force on the frames to attach the other side of the back brace.

*May require 2 people.



Set the shims against the frame.

Place the U-bolts through the shim and first-half of the frame.

This will point the U-bolts outwards, allowing the axle of the wheel to be placed in-between in the next step.

*Up to 3 sets of shims can be used per wheelbarrow, increasing the height of the frame by $\frac{3}{4}$ " off the ground.

* 1 set of shims is supplied with every wheelbarrow, additional sets available for purchase.



Place the wheel onto the frame between the U-bolts and center as best as possible.

Place the U-bolts all the way through the frame and put on flange nuts to hold in place.

* CAUTION: Do not fully tighten one side before the other as this can bend the axle or deform the U-bolt. Make sure both sides U-bolts are snug before fully tightening.



Push "handle to frame" end-caps into the frame.



Push handles into frame and line up holes in the handle with the holes in frame. Install bolts from the “underside” of the frame. This allows the user to slide their hands along the bottom-side of the frame when grabbing the frame closer to the tub.

*May need a rubber mallet to tap handles into the frame.



Push handle end cap into the end of the handle to prevent the frame from filling with material.

*May need to tap the cap into the handle with a rubber mallet.



Insert one of the supplied Serial Number stickers inside the crosspiece brace from the left side. Make sure the sticker is pressed firmly all the way onto the brace.



Place the second Serial Number sticker on the outside of the crosspiece brace on the right side, and then install crosspiece brace end-caps to prevent filling with material.

* You may need to use a rubber mallet to tap end-caps into the crosspiece brace, but be careful not to break the caps.

This completes the assembly of a Cariola Wheelbarrow. Now all of the bolts can be tightened, ensuring they are pulled flush with the frame, locking them into place. It is recommended to lightly “bounce” the wheelbarrow nose against a hard surface to make sure everything is properly aligned after tightening all the bolts.

TUB CHOICES

ID	Part #	Description	Qty
1A	M-TUB6.75	Tub, Black, 6.75 cu.ft.	1
1B	M-TUB7.75	Tub, Black, 7.75 cu.ft.	1



FRAME KIT (Part # M-FRAME) CORE PARTS

(also includes FRAME KIT PARTS BREAKDOWN on next page)

ID	Part #	Description	Qty
2	204	Brace, Nose	1
3	202	Brace, Crosspiece	1
4	205	Plastic End Cap for the Brace, Crosspiece	2*
5	203	Brace, Back	1
6	201	Frame Piece	2

FRAME KIT PARTS BREAKDOWN

Pg 10

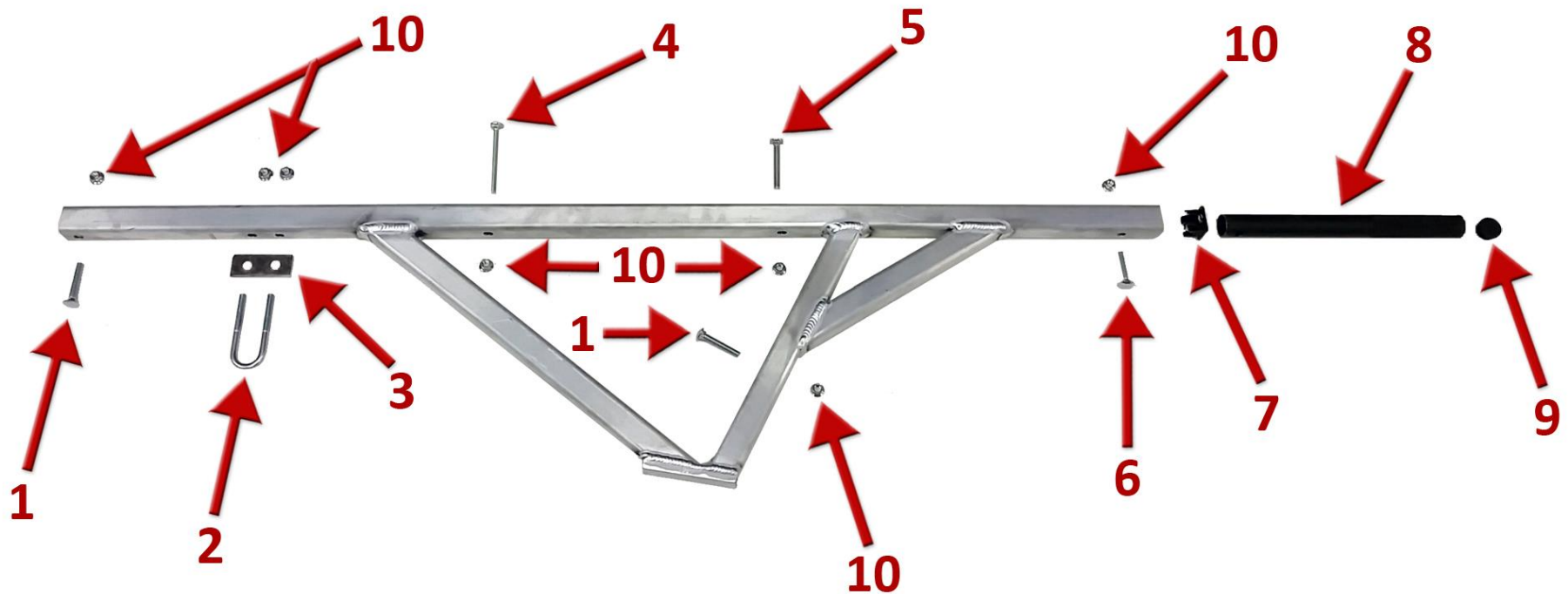

ID	Part #	Description	Qty
1	301	Carriage Bolts for Brace, Back & Brace, Nose (2-1/4" x 3/8")	4*
2	304	U-Bolt for Wheel	2*
3	200	Shim (1/4")	2*
4	303	Carriage Bolt for Tub (4" x 3/8")	2*
5	302	Carriage Bolt for Tub (2-3/4" x 3/8")	2*
6	300	Carriage Bolt for Handle (2" x 3/8")	2*
7	206	Plastic End Cap for Frame to Handle	2*
8	208	Handle, Knurled	2
9	207	Plastic End Cap for Handle	2*
10	306	Flange Nut (3/8")	14*

SINGLE WHEEL KIT BREAKDOWN

(Kit Part # M-TIREAIRSNG or Kit Part # M-TIREFOAMSNG)

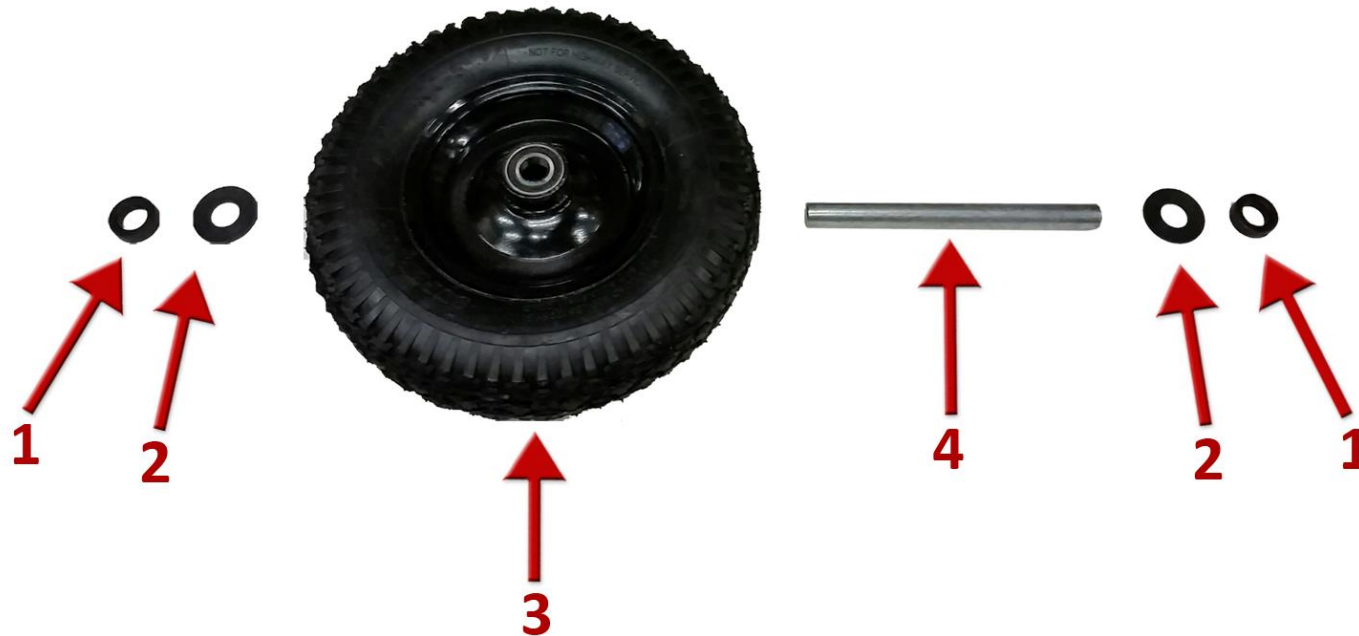

ID	Part #	Description	Qty
1	405	Shaft Collar, Axle (1")	2
2	404	Plastic Washer, Axle	2
3	400 or 401	See Page 14 For Wheel Choices	1
4	402	Axle, Single Wheel (10-1/2")	1

DUAL WHEEL KIT BREAKDOWN

(Kit Part # M-TIREAIRDUAL or Kit Part # M-TIREFOAMDUAL)

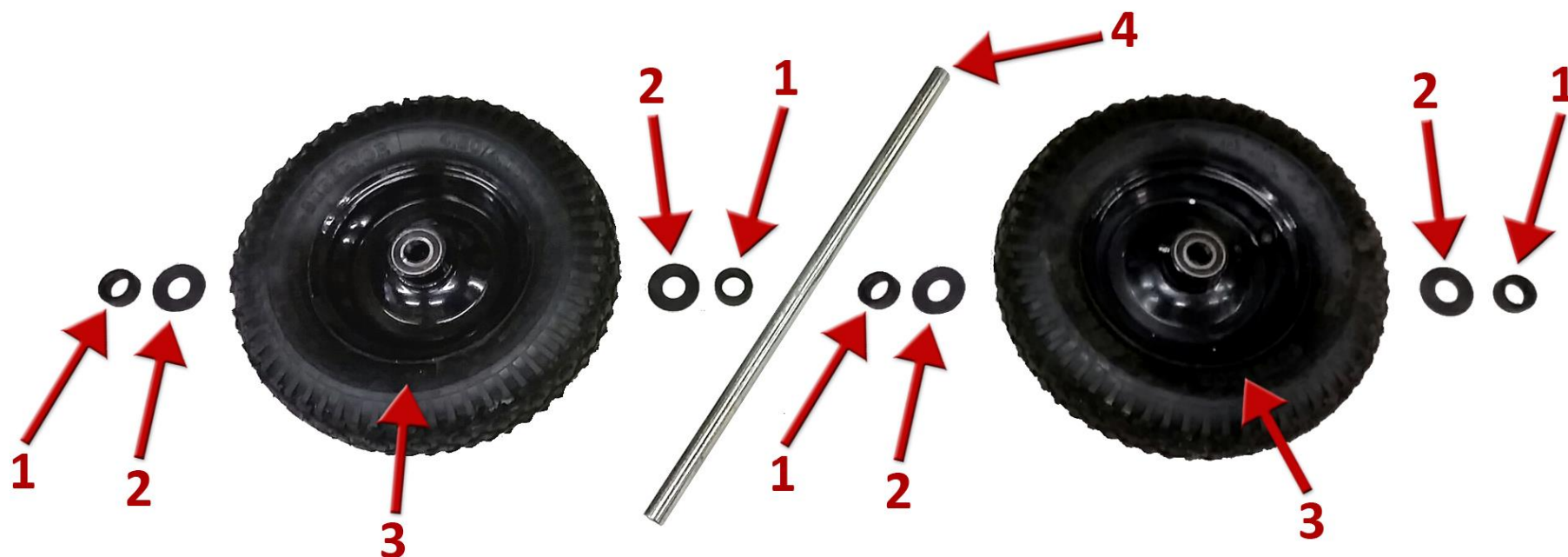

ID	Part #	Description	Qty
1	405	Shaft Collar, Axle (1")	4
2	404	Plastic Washer, Axle	4
3	400 or 401	See Page 14 For Wheel Choices	2
4	403	Axle, Dual Wheel (24")	1

SINGLE TO DUAL WHEEL CONVERSION KIT BREAKDOWN

(Kit Part # M-CONVAIR or Kit Part # M-CONVFOAM)



ID	Part #	Description	Qty
1	405	Shaft Collar, Axle (1")	2
2	404	Plastic Washer, Axle	2
3	400 or 401	See Page 14 For Wheel Choices	1
4	403	Axle, Dual Wheel (24")	1

WHEEL CHOICES



Pneumatic Wheel with Puncture-Resistant Solution
Part #: 400



Solid Foam Wheel
Part #: 401

PARTS BOX KIT BREAKDOWN

(Kit Part # M-BOX)

Pg 15



ID	Part #	Description	Qty
1	500	Cariola Cardboard Box	1
2A	M-TIREAIRSNG or M-TIREFOAMSNG	Wheel Kits Sold Separately	1
2B	M-TIREAIRDUAL or M-TIREFOAMDUAL	See Pages 11 & 12 for Options	1
3	208	Handle, Knurled	2
4	202	Brace, Tub (1-1/2")	1
5	Parts Bag	See *Items On Pages 9 & 10	1
6	204	Brace, Nose	1
7	203	Brace, Back	1